

# ReidBrace<sup>TM</sup> Installation Guide

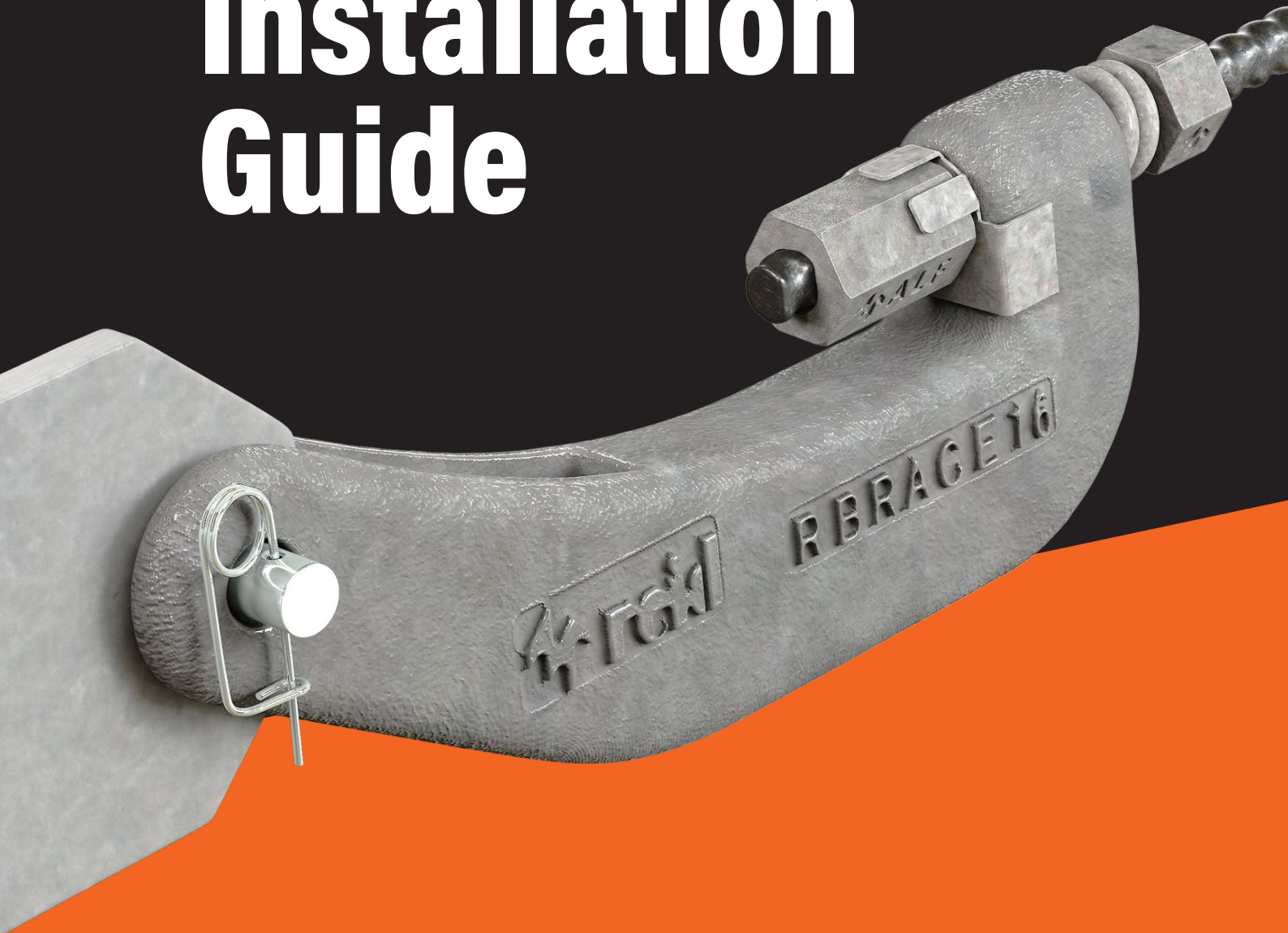

For more information on our products call  
**1300 780 063**  
or go on [www.ramset.com.au](http://www.ramset.com.au)



# ReidBrace™

## Installation Guidelines



### Step 1: Checks

1. Check if all RBRACE components are in the box.
2. Check if the RBRACE fitting flanges will fit onto the steel cleat.

### Boxed Set contents:

1. Reid™ Tension Spring
2. Reid™ Tab Washer
3. RBRACE
4. RBRACE-END
5. Pin and Clip
6. Full nut & Half Nut\*  
\*full nut may be supplied in lieu of half nut, depending on product availability.

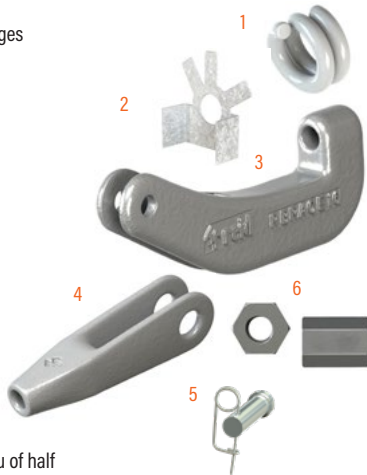

### Step 2: Measure

1. Measure the centre to centre distance between the holes on the steel cleat.
2. Subtract the above length by A+B as per the following table. This is the length of ReidBar™ to be cut.

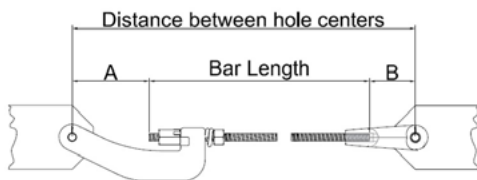

ReidBar™ Size	RBRACE	A ± 5mm	RBRACE-END	B ± 5mm	A + B (mm)
RB12	RBRACE12/16	135	RBRACE12-END	75	210
RBA16	RBRACE12/16	130	RBRACE16-END	80	210
RBA20	RBRACE20	170	RBRACE20-END(A)	105	280
RB25	RBRACE25	175	RBRACE25-END	125	300
RB32	RBRACE32 V2	200	RBRACE32-V2-END	135	335

### Step 3: Assemble



1. Insert ReidBar™ into the RBRACE-END fitting and tighten.
2. For guidance on coupling ReidBar™ lengths in Australia and New Zealand respectively:  
[ramset.com.au/product/reidbrace/](http://ramset.com.au/product/reidbrace/)  
[ramset.co.nz/product/reidbrace/](http://ramset.co.nz/product/reidbrace/)
3. Insert ReidBar™ Half Nut (or one full nut in 20mm sets) into the other side of the bar, followed by inserting the tension spring.
4. Slide the RBRACE Fitting onto the ReidBar™, followed by inserting the tab washer onto the ReidBar™ with the tabs facing the nut.

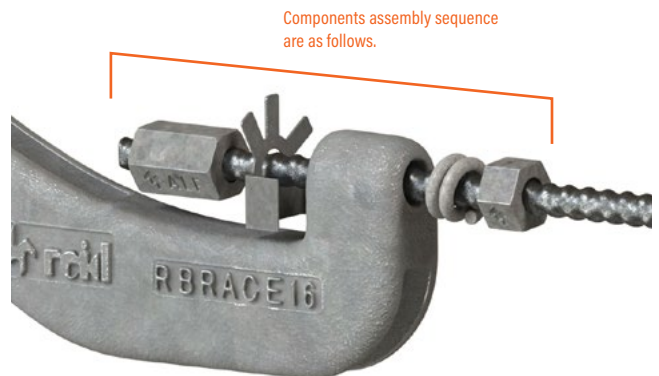

5. Wind ReidBar™ Nut onto the ReidBar™ until it is flush with the end of the ReidBar™. This will give adjustability to the RBRACE fitting upon installation.

# ReidBrace™

## Installation Guidelines

### Step 4: Install

1. Lift the ReidBrace™ assembly into location.
2. Fix the RBRACE-END fitting onto the steel cleat using the pin supplied in the box set. Clip through hole in pin.

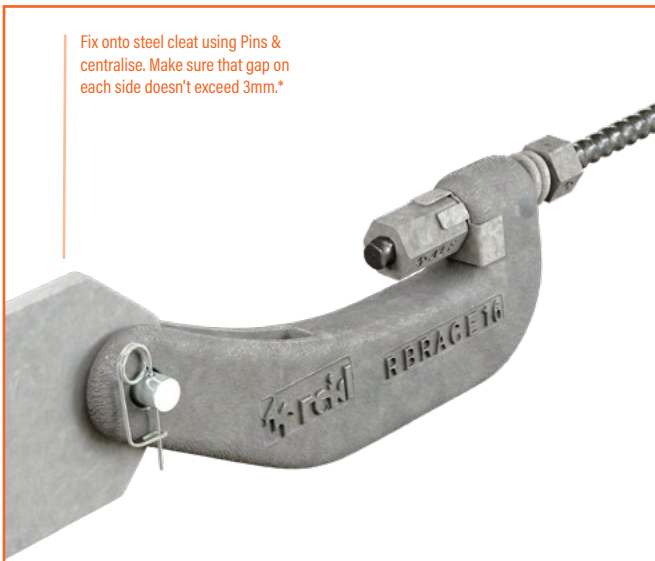

3. Place necessary means to prop the ReidBrace™ assembly so that the sag of the brace is not excessive. A sag of 1 in 100 is recommended as a maximum deflection (refer to HERA: Seismic Design of Steel Structures).
4. Fix the RBRACE fitting onto the steel cleat using the pin supplied in the box set. Fix clip through hole in pin.
5. Adjust the positions of the nuts so that the 1 in 100 maximum deflection criteria is met.
6. Tighten the Nut to fully compress the tension spring. Fold the tab washers onto the ReidBar™ Nut.

### Step 5: Check

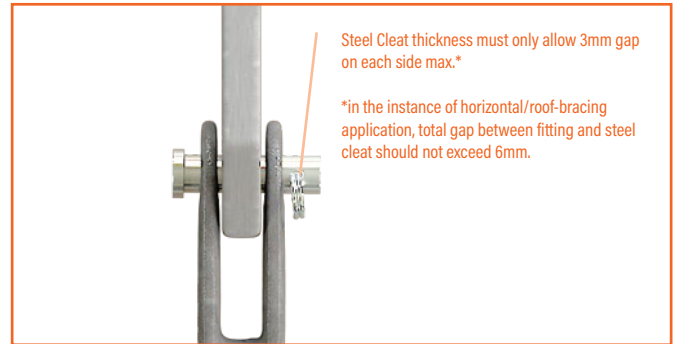

1. ReidBar™ is tightly fastened into the RBRACE-END fitting.
2. The deflection of the brace shall not exceed 1 in 100 of the brace length.

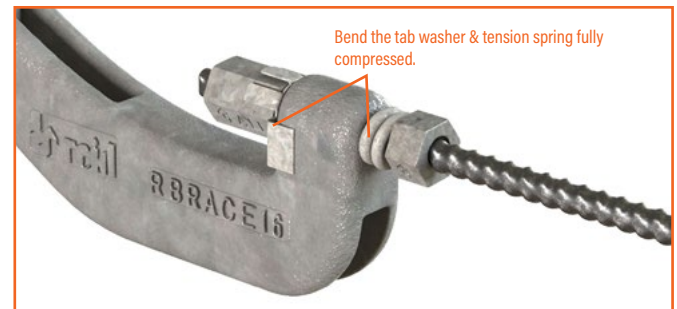

3. Tension spring is fully compressed.
4. Ensure that the sequence of the ReidBar™ Full Nut and Half Nut is as shown as the above image, and not the wrong way around.
5. Tab washer is folded onto the ReidBar™ Nut.
6. Supplied Pins and Clips are securely fixed to steel.
7. Steel cleat thickness must only allow 3mm gap each side of the ReidBrace™ fitting (or total maximum of 6mm in the case of horizontal/roof-bracing).

\*Cyclic testing of ReidBrace™ has been carried out simulating horizontal/roof-bracing application. Therefore in the instance of horizontal/roof-bracing application, it is acceptable for the ReidBrace™ Fitting to sit flush against the steel fixture, as long as the total gap doesn't exceed 6mm.

**Important Disclaimer:** Any engineering information or advice ("Information") provided by Ramset™ in this document is issued in accordance with a prescribed standard, published performance data or design software. It is the responsibility of the user to obtain its own independent engineering (or other) advice to assess the suitability of the Information for its own requirements. To the extent permitted by law, Ramset™ will not be liable to the recipient or any third party for any direct or indirect loss or liability arising out of, or in connection with, the Information.

## Customer Service

---

### Ramset™ Australia

Sales, Orders and Enquiries

Tel: 1300 780 063

Email: [enquiry@ramset.com.au](mailto:enquiry@ramset.com.au)

Web: [www.ramset.com.au](http://www.ramset.com.au)

### Website:

[www.ramset.com.au](http://www.ramset.com.au)



Keep up to date with  
Ramset™ on our socials'



---

Ramset™ 1 Ramset Drive, Chirside Park 3116

Information in this document is correct at the time of printing. Readers should contact Ramset™ or consult Ramset™ detailed technical information to ensure product is suitable for intended use prior to purchase. ITW Australia Pty Ltd ABN 63 004 235 063 trading as Ramset™  
© Copyright 2025.™ Trademarks of Cetram Pty. Ltd. Used under license by Ramset™

CBI569 PDL

