

WERCS AnkaScrew™

SCREW IN ANCHORS

Brick & Block Anchoring

GENERAL INFORMATION

Performance Related	Material	Installation Related

Product

The WERCS AnkaScrew Anchor is a medium duty, rotation setting thread forming anchor.

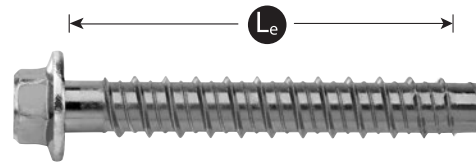

Benefits, Advantages and Features

Fast and easy to install:

- Simply screws into hole.

Fast and easy to remove:

- Screws out leaving an empty hole with no protruding metal parts to grind off.

Close to edge and for close anchor spacing:

- Does not expand and burst brick and block.

Principal Applications into Brick and Block

- Wall mounted pipe brackets.
- Gate hinges.

Installation

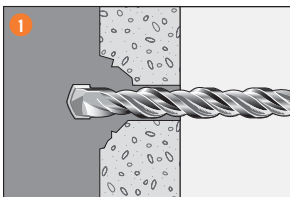

1. Drill hole to correct diameter and depth.

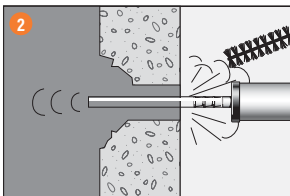

2. Clean thoroughly with brush. Remove debris by way of vacuum or hand pump, compressed air etc.

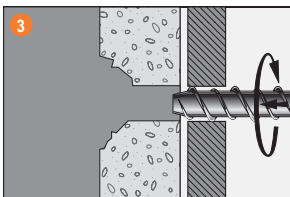

3. Using a socket wrench, screw the AnkaScrew into the hole using slight pressure until the self tapping action starts.

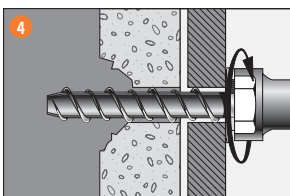

4. Tighten the AnkaScrew. If resistance is experienced when tightening, unscrew anchor one turn and re-tighten. Ensure not to over tighten.

WERCS AnkaScrew™

SCREW IN ANCHORS

Installation and Working Load Limit performance details

Anchor size, d_b (mm)	Installation details				Working Load Limit (kN)							
	Drilled hole diameter, d_h (mm)	Fixture hole diameter, d_f (mm)	Anchor effective depth, h (mm)	Tightening torque, T_t (Nm)	Solid Brick		3 Hole Brick		10 Hole Brick		Concrete Block	
					Shear, V_a	Tension, N_a	Shear, V_a	Tension, N_a	Shear, V_a	Tension, N_a	Shear, V_a	Tension, N_a
5	5	7	25	8	1.5	1.2	1.2	1.0	1.1	0.5	1.2	0.8
6	6	8	30	10	3.2	1.8	3.0	2.4	1.8	0.60	2.1	0.90
8	8	10	40	10	4.0	2.7	3.8	2.7	2.3	0.65	2.1	1.00
10	10	12	50	15	4.4	3.9	4.2	2.8	2.5	0.65	2.1	1.00
12	12	15	60	15	4.4	4.5	4.2	3.0	2.5	0.70	2.1	1.15

DESCRIPTION AND PART NUMBERS

Anchor size, d_b	Effective length, L_e (mm)	Part No.	
		Zn Hex Head	Gal Hex Head
5	24	AS05030	-
6	44	AS06050W100	AS06050WGM100
	69	AS06075W100	AS06075WGM100
	94	AS060100W100	AS060100WGM100
8	54	AS08060W100	AS08060WGM100
	69	AS08075W100	AS08075WGM100
	94	AS080100W100	AS080100WGM100
10	54	AS10060W50	AS10060WGM50
	69	AS10075W50	AS10075WGM50
	94	AS10100W50	AS10100WGM50
12	69	AS12075W50	AS12075WGM50
	94	AS12100W50	AS12100WGM50
	144	AS12150W20	AS12150WGM20

Effective depth, h (mm)

$$h = L_e - t$$

t = total thickness of material(s) being fixed

ENGINEERING PROPERTIES

Anchor size, d_h (mm)	Stress area, A_s (mm ²)	Yield strength, f_y (MPa)	UTS, f_u (MPa)
6	15.9	640	800
8	42.4	640	800
10	69.4	640	800
12	84.1	640	800